

# MUSIC CABINETS

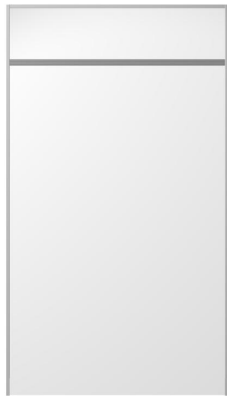

All TMI catalog sections are available online at: [www.tmisystems.com/products/reference](http://www.tmisystems.com/products/reference)

TMI PRODUCT NO.	PERSPECTIVE	DESCRIPTION & DIMENSIONS
-----------------	-------------	--------------------------



Open music cabinet 60" wide x 84-1/2" high. Available in 29" or 39" depth.  
 1 Compartment, 58-1/2" wide x 9-7/8" high, at the top.  
 1 Compartment, 58-1/2" wide x 72-7/8" high, at the bottom.  
 Cabinet is open at the bottom for large, wheel-in instrument storage.

#### RECOMMENDED STORAGE

**29" Depth:** Timpani, Chimes, Xylophone, Marimbas, Small Vibes

**39" Depth:** Timpani, Chimes, Xylophone, Marimbas, Small Vibes

#### DOOR OPTIONS

**M2056** Two Full Height Solid Laminated Doors

**M3056** Two Full Height Wire Grille Doors

**M1056**



Open music cabinet 27" wide x 84-1/2" high. Available in 23" or 29" depth.  
 1 Compartment 25-3/8" wide x 9-7/8" high at the top.  
 1 Compartment 25-3/8" wide x 67-7/8" high at the bottom with a closet rod.

#### RECOMMENDED STORAGE

**23" Depth:** Uniform Accessories in the top.  
 Uniforms, Robes in the bottom.

**29" Depth:** Uniform Accessories in the top.  
 Uniforms, Robes in the bottom.

#### DOOR OPTIONS

**M2100** One Full Height Solid Laminated Door

**M3100** One Full Height Wire Grille Door

**M1100**



Open music cabinet 48" wide x 84-1/2" high. Available in 23" or 29" depth.  
 1 Compartment 46-1/2" wide x 9-7/8" high at the top.  
 1 Compartment 46-1/2" wide x 67-7/8" high at the bottom with a closet rod.

#### RECOMMENDED STORAGE

**23" Depth:** Uniform Accessories in the top.  
 Uniforms, Robes in the bottom.

**29" Depth:** Uniform Accessories in the top.  
 Uniforms, Robes in the bottom.

#### DOOR OPTIONS

**M2101** Two Full Height Solid Laminated Doors

**M3101** Two Full Height Wire Grille Doors

**M1101**



All TMI catalog sections are available online at: [www.tmisystems.com/products/reference](http://www.tmisystems.com/products/reference)

TMI PRODUCT NO.	PERSPECTIVE	DESCRIPTION & DIMENSIONS
-----------------	-------------	--------------------------



Open music cabinet 27" wide x 84-1/2" high. Available in 23" or 29" depth. With two closet rods.

**RECOMMENDED STORAGE**

**23" Depth:** Uniforms, Robes.

**29" Depth:** Uniforms, Robes.

**DOOR OPTIONS**

**M2104** One Full Height Solid Laminated Door

**M3104** One Full Height Wire Grille Door

**M1104**

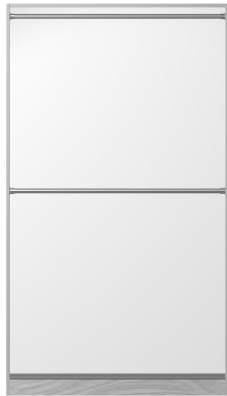

Open music cabinet 48" wide x 84-1/2" high. Available in 23" or 29" depth. With two closet rods.

**RECOMMENDED STORAGE**

**23" Depth:** Uniforms, Robes.

**29" Depth:** Uniforms, Robes.

**DOOR OPTIONS**

**M2105** Two Full Height Solid Laminated Doors

**M3105** Two Full Height Wire Grille Doors

**M1105**



Open music cabinet 27" wide x 84-1/2" high. Available in 23" or 29" depth. 3 Equal compartments, each 25-3/8" wide x 10" high at the top. 1 Compartment 25-3/8" wide x 76" high at the bottom with a closet rod.

**RECOMMENDED STORAGE**

**23" Depth:** Hats, Uniform Accessories in the top. Uniforms, Robes in the bottom.

**29" Depth:** Hats, Uniform Accessories in the top. Uniforms, Robes in the bottom.

**DOOR OPTIONS**

**M2150** One Full Height Solid Laminated Door

**M3150** One Full Height Wire Grille Door

**M1150**



All TMI catalog sections are available online at: [www.tmisystems.com/products/reference](http://www.tmisystems.com/products/reference)

TMI PRODUCT NO.	PERSPECTIVE	DESCRIPTION & DIMENSIONS
-----------------	-------------	--------------------------



Open music cabinet 48" wide x 84-1/2" high. Available in 23" or 29" depth. 3 Equal compartments, each 46-1/2" wide x 10" high at the top. 1 Compartment 46-1/2" wide x 76" high at the bottom with a closet rod.

**RECOMMENDED STORAGE**

**23" Depth:** Hats, Uniform Accessories in the top. Uniforms, Robes in the bottom.

**29" Depth:** Hats, Uniform Accessories in the top. Uniforms, Robes in the bottom.

**DOOR OPTIONS**

**M2151** Two Full Height Solid Laminated Doors

**M3151** Two Full Height Wire Grille Doors

**M1151**

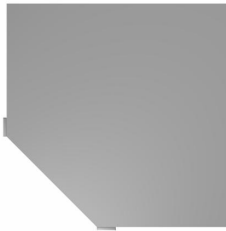

Open music cabinet 48" wide x 84-1/2" high x 48" deep. With diagonal face and center structural metal post to accommodate revolving shelves or garment racks.

*This unit is shipped knocked-down and assembled in the field.*

**RECOMMENDED STORAGE**

Uniforms, Robes, Accessories

**DOOR OPTIONS**

**M2368** One Full Height Solid Laminated Door

**M3368** One Full Height Wire Grille Door

**M1368**



Open music cabinet 48" wide x 84-1/2" high x 48" deep. With diagonal face, one fixed shelf and a closet rod.

*This unit is shipped knocked-down and assembled in the field.*

**RECOMMENDED STORAGE**

Uniforms, Robes, Accessories

**DOOR OPTIONS**

**M2369** One Full Height Solid Laminated Door

**M3369** One Full Height Wire Grille Door

**M1369**



All TMI catalog sections are available online at: [www.tmisystems.com/products/reference](http://www.tmisystems.com/products/reference)

TMI PRODUCT NO.	PERSPECTIVE	DESCRIPTION & DIMENSIONS
-----------------	-------------	--------------------------



Open music cabinet 27" wide x 68-3/4" high. Available in 29" or 39" depth. Eight equal compartments, each 12-3/8" wide x 14-1/2" high.

**RECOMMENDED STORAGE**

**29" Depth:** Alto Saxophone, Cornet, Trumpet

**39" Depth:** Alto Clarinet, Bassoon, Bass Clarinet, Tenor Saxophone, Trombone, Violin, Viola

**DOOR OPTIONS**

**M2604** One Full Height Solid Laminated Door

**M3604** One Full Height Wire Grille Door

**M4604** Eight Individual Solid Laminated Doors

**M5604** Eight Individual Wire Grille Doors

**M1604**

Revolving metal shelf, epoxy powder coated, 40" diameter. Designed for use in M1368 corner cabinets.

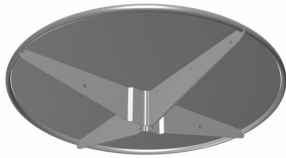
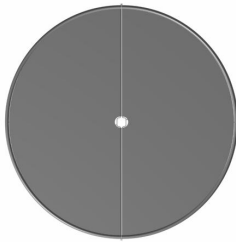

**RECOMMENDED STORAGE**

Accessories.

**A8910**

Revolving metal shelf, epoxy powder coated, 40" diameter. With garment hanging ring, designed for use in M1368 corner cabinets.

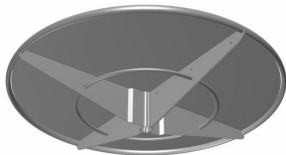
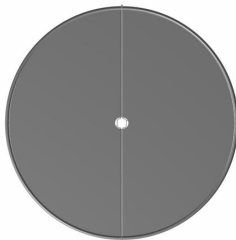

**RECOMMENDED STORAGE**

Uniforms, Robes, Accessories.

**A8911**



All TMI catalog sections are available online at: [www.tmisystems.com/products/reference](http://www.tmisystems.com/products/reference)

TMI PRODUCT NO.	PERSPECTIVE	DESCRIPTION & DIMENSIONS
-----------------	-------------	--------------------------

Revolving metal garment ring, epoxy powder coated, 23" diameter. Designed for use with M1368 corner cabinets.

**RECOMMENDED STORAGE**

Uniforms, Robes

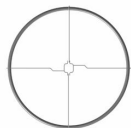

**A8915**

Oak instrument storage frame on casters, with space for 3 instruments. Overall dimensions: 50" wide x 56" high x 26" deep.

**RECOMMENDED STORAGE**

Bass Viola



**X9100**

Oak instrument storage frame on casters, with space for 4 instruments. Overall dimensions: 50" wide x 37" high x 24" deep.

**RECOMMENDED STORAGE**

Cello



**X9105**