



All TMI catalog sections are available online at: www.tmisystems.com/products/reference

TMI PRODUCT NO.	PERSPECTIVE	DESCRIPTION & DIMENSIONS
-----------------	-------------	--------------------------



M1000

Open music cabinet 27" wide x 84-1/2" high. Available in 29" or 39" depth. 15 Equal compartments, each 8" wide x 14-1/2" high.

RECOMMENDED STORAGE

29" Depth: Clarinet, Flute, Oboe, Piccolo

39" Depth: Clarinet, Flute, Oboe, Piccolo

DOOR OPTIONS

M2000 One Full Height Solid Laminated Door

M3000 One Full Height Wire Grille Door

M4000 15 Individual Solid Laminated Doors

M5000 15 Individual Wire Grille Doors



M1004

Open music cabinet 27" wide x 84-1/2" high. Available in 29" or 39" depth. 10 Equal compartments, each 12-3/8" wide x 14-1/2" high.

RECOMMENDED STORAGE

29" Depth: Alto Saxophone, Cornet, Trumpet

39" Depth: Alto Clarinet, Bassoon, Bass Clarinet, Tenor Saxophone, Trombone, Violin, Viola

DOOR OPTIONS

M2004 One Full Height Solid Laminated Door

M3004 One Full Height Wire Grille Door

M4004 10 Individual Solid Laminated Doors

M5004 10 Individual Wire Grille Doors



M1008

Open music cabinet 23" wide x 84-1/2" high. Available in 29" or 39" depth. 5 Equal compartments, each 8" wide x 14-1/2" high, on the left. 5 Equal compartments, each 12-3/8" x 14-1/2" high, on the right.

RECOMMENDED STORAGE

29" Depth: Clarinet, Flute, Oboe, Piccolo in the left.
Alto Saxophone, Cornet, Trumpet in the right.

39" Depth: Clarinet, Flute, Oboe, Piccolo in the left.
Alto Clarinet, Bassoon, Bass Clarinet, Tenor Saxophone, Trombone, Violin, Viola in the right.

DOOR OPTIONS

M2008 One Full Height Solid Laminated Door

M3008 One Full Height Wire Grille Door

M4008 10 Individual Solid Laminated Doors

M5008 10 Individual Wire Grille Doors



All TMI catalog sections are available online at: www.tmisystems.com/products/reference

TMI PRODUCT NO.	PERSPECTIVE	DESCRIPTION & DIMENSIONS
-----------------	-------------	--------------------------

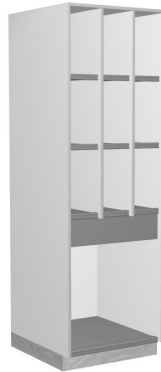

M1012

Open music cabinet 27" wide x 84-1/2" high. Available in 29" or 39" depth.
 9 Equal compartments, each 8" wide x 14-1/2" high, at the top.
 1 Compartment, 25-3/8" wide x 25" high, at the bottom.

RECOMMENDED STORAGE

- 29" Depth:** Clarinet, Flute, Oboe, Piccolo in the top.
 Alto Horn, French Horn, Snare Drum in the bottom.
- 39" Depth:** Clarinet, Flute, Oboe, Piccolo in the top.
 Baritone, Euphonium, Mellophone in the bottom.

DOOR OPTIONS

- M2012** One Full Height Solid Laminated Door
- M3012** One Full Height Wire Grille Door
- M4012** 10 Individual Solid Laminated Doors
- M5012** 10 Individual Wire Grille Doors



M1016

Open music cabinet 27" wide x 84-1/2" high. Available in 29" or 39" depth.
 6 Equal compartments, each 12-3/8" wide x 14-1/2" high at the top.
 1 Compartment, 25-3/8" wide x 25" high at the bottom.

RECOMMENDED STORAGE

- 29" Depth:** Alto Saxophone, Cornet, Trumpet in the top.
 Alto Horn, French Horn, Snare Drum in the bottom.
- 39" Depth:** Alto Clarinet, Bassoon, Bass Clarinet, Tenor Saxophone, Trombone,
 Violin, Viola in the top.
 Baritone, Euphonium, Mellophone in the bottom.

DOOR OPTIONS

- M2016** One Full Height Solid Laminated Door
- M3016** One Full Height Wire Grille Door
- M4016** Seven Individual Solid Laminated Doors
- M5016** Seven Individual Wire Grille Doors



M1020

Open music cabinet 14" wide x 84-1/2" high. Available in 29" or 39" depth.
 5 Equal compartments, each 12-3/8" wide x 14-1/2" high.

RECOMMENDED STORAGE

- 29" Depth:** Alto Saxophone, Cornet, Trumpet
- 39" Depth:** Alto Clarinet, Bassoon, Bass Clarinet, Tenor Saxophone, Trombone,
 Violin, Viola

DOOR OPTIONS

- M2020** One Full Height Solid Laminated Door
- M3020** One Full Height Wire Grille Door
- M4020** Five Individual Solid Laminated Doors
- M5020** Five Individual Wire Grille Doors



All TMI catalog sections are available online at: www.tmisystems.com/products/reference

TMI PRODUCT NO.	PERSPECTIVE	DESCRIPTION & DIMENSIONS
-----------------	-------------	--------------------------

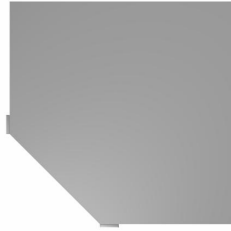

Open music cabinet 48" wide x 84-1/2" high x 48" deep. With diagonal face and one fixed music shelf.

This unit is shipped knocked-down and assembled in the field.

RECOMMENDED STORAGE

Large over-sized instruments and equipment.

DOOR OPTIONS

M2370 One Full Height Solid Laminated Door

M3370 One Full Height Wire Grille Door

M1370

Open music cabinet 27" wide x 36-3/4" high. Available in 29" or 39" depth. Six equal compartments, each 8" wide x 14-1/2" high.

RECOMMENDED STORAGE

29" Depth: Clarinet, Flute, Oboe, Piccolo

39" Depth: Clarinet, Flute, Oboe, Piccolo



DOOR OPTIONS

M2500 One Full Height Solid Laminated Door

M3500 One Full Height Wire Grille Door

M4500 Six Individual Solid Laminated Doors

M5500 Six Individual Wire Grille Doors

M1500

Open music cabinet 27" wide x 36-3/4" high. Available in 29" or 39" depth. Four equal compartments, each 12-3/8" wide x 14-1/2" high.

RECOMMENDED STORAGE

29" Depth: Alto Saxophone, Cornet, Trumpet

39" Depth: Alto Clarinet, Bassoon, Bass Clarinet, Tenor Saxophone, Trombone, Violin, Viola



DOOR OPTIONS

M2504 One Full Height Solid Laminated Door

M3504 One Full Height Wire Grille Door

M4504 Four Individual Solid Laminated Doors

M5504 Four Individual Wire Grille Doors

M1504



All TMI catalog sections are available online at: www.tmisystems.com/products/reference

TMI PRODUCT NO.	PERSPECTIVE	DESCRIPTION & DIMENSIONS
-----------------	-------------	--------------------------



Open music cabinet 27" wide x 68-3/4" high. Available in 29" or 39" depth. Eight equal compartments, each 12-3/8" wide x 14-1/2" high.

RECOMMENDED STORAGE

29" Depth: Alto Saxophone, Cornet, Trumpet

39" Depth: Alto Clarinet, Bassoon, Bass Clarinet, Tenor Saxophone, Trombone, Violin, Viola

DOOR OPTIONS

M2604 One Full Height Solid Laminated Door

M3604 One Full Height Wire Grille Door

M4604 Eight Individual Solid Laminated Doors

M5604 Eight Individual Wire Grille Doors

M1604

Revolving metal shelf, epoxy powder coated, 40" diameter. Designed for use in M1368 corner cabinets.

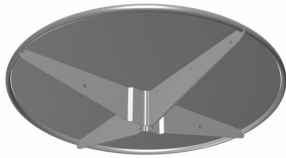
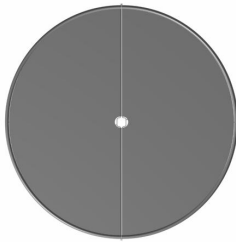

RECOMMENDED STORAGE

Accessories.

A8910

Revolving metal shelf, epoxy powder coated, 40" diameter. With garment hanging ring, designed for use in M1368 corner cabinets.

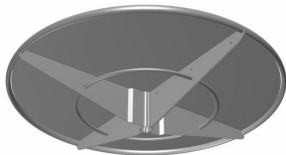
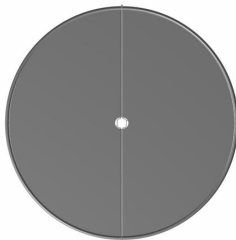

RECOMMENDED STORAGE

Uniforms, Robes, Accessories.

A8911